

A
SCALE: 1 : 2
The same for all four corners

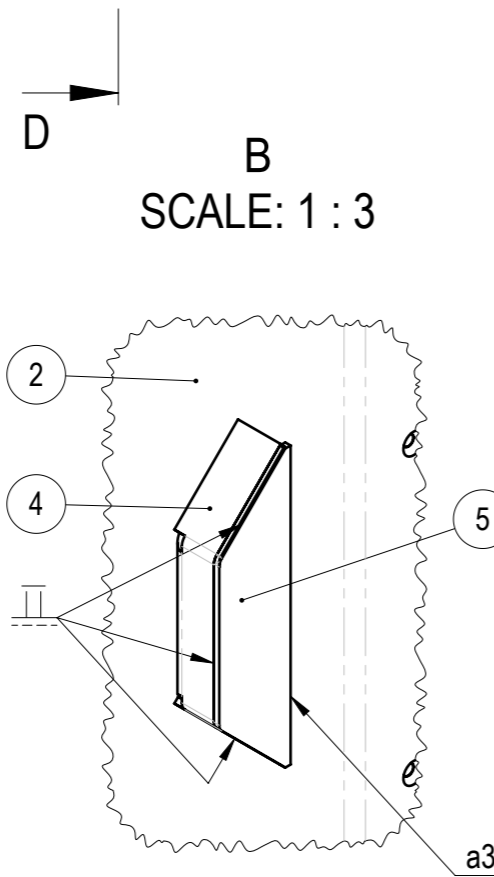

B
SCALE: 1 : 3

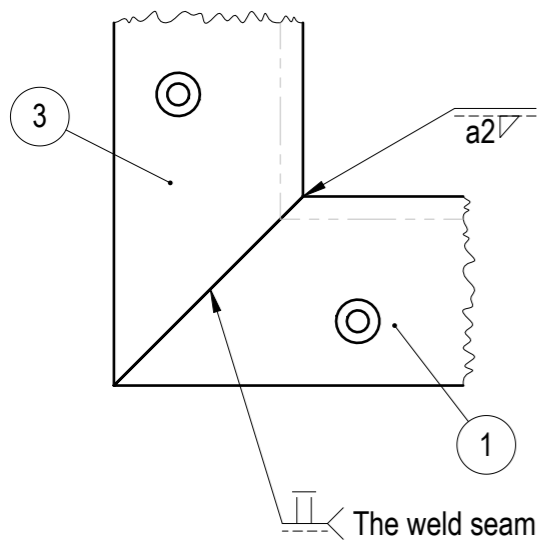
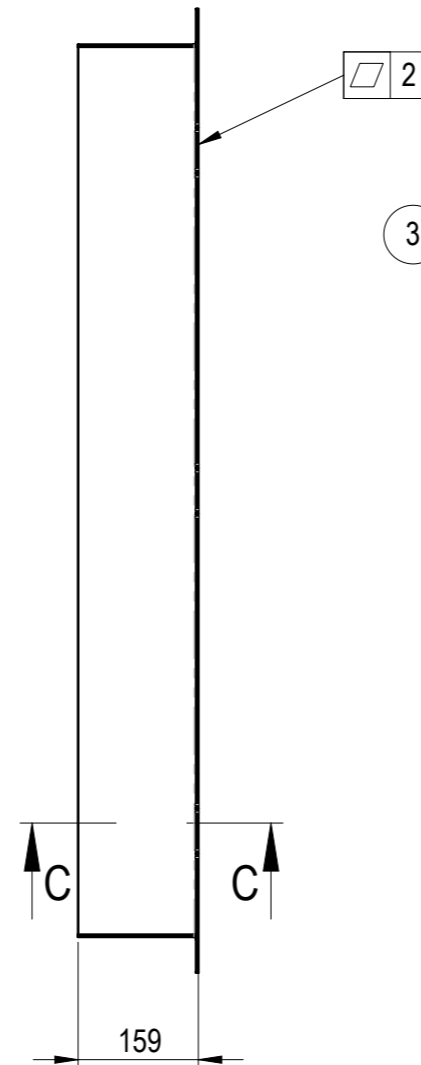

View from the other side
Grind all sharp edges

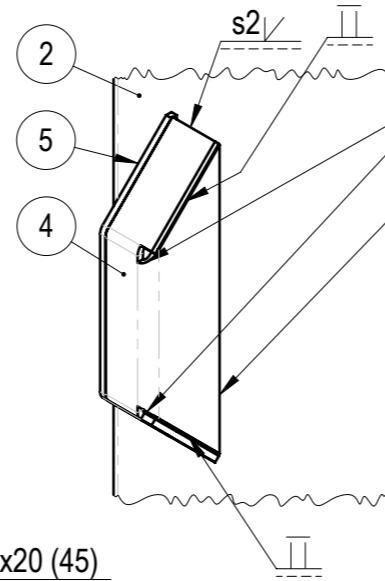

Weld the gap and sand it down

a3 3x20 (45)

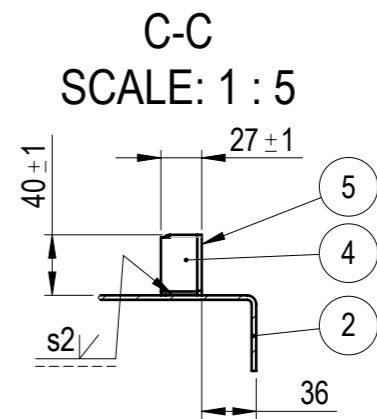

C-C
SCALE: 1 : 5

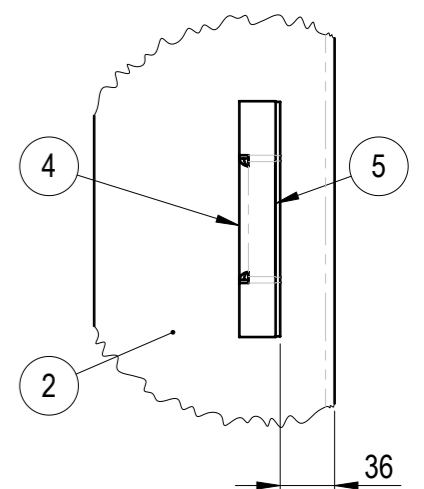

D-D
SCALE: 1 : 5

NO.	PART NO	DESCRIPTION	MATERIAL	PROCESSING	REVISION	WEIGHT	QTY
1	105-30232-01	Sheet 4	S355JR	LCB CND		2.48	2
2	105-30232-02	Sheet 5	S355JR	LCB CND		5.65	1
3	105-30232-03	Sheet 6	S355JR	LCB CND		5.78	1
4	105-30232-04	Latch gripper	S355JR	LCB		0.20	1
5	105-30232-05	Plate	S355JR	LC		0.11	1

WEMPS
ENGINEERING SERVICES

MATERIAL	WEIGHT	DEBURR AND BREAK SHARP EDGES	REVISION	DATE
-	16.705 Kg	DO NOT SCALE DRAWING		13.05.2025
SURFACE PROTECTION	MACHINING	THERMAL CUTTING	WELDING	SCALE
Painting C3.09 ISO12944	ISO 2768 mK	ISO 9013 221	ISO 13920 BF	1:10
NAME	SIGNATURE	PART NO.	FORMAT	
Designed by E. Kriviss		105-30232-00	A3	
Drawn by M. Supols		DESCRIPTION	SHEET 1/1	
Technical ref.		Outer hatch frame		